

V7MN

Volantino 7 Punte Nylon con Perno Filettato

Nylon Star Knob 7 Points, Threaded Stud



Cod.	D	d	l	H	h	d1	Peso Weight - gr	U.V.
B1V7MN200410	20	04MA	10	11	5	12	6	20
B1V7MN200420	20	04MA	20	11	5	12	6	20
B1V7MN200430	20	04MA	30	11	5	12	6	20
B1V7MN200440	20	04MA	40	11	5	12	6	20
B1V7MN200450	20	04MA	50	11	5	12	6	20
B1V7MN200510	20	05MA	11	11	5	12	7	20
B1V7MN200520	20	05MA	20	11	5	12	7	20
B1V7MN200530	20	05MA	30	11	5	12	7	20
B1V7MN200540	20	05MA	40	11	5	12	7	20
B1V7MN200550	20	05MA	50	11	5	12	7	20
B1V7MN200610	20	06MA	12	11	5	12	8	20

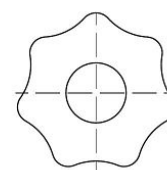
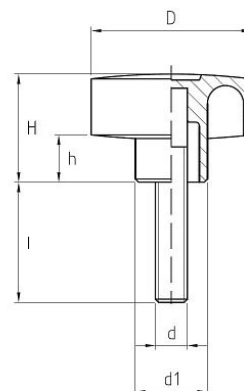

Continua da V7MN.

Cod.	D	d	l	H	h	d1	Peso Weight - gr	U.V.
B1V7MN200615	20	06MA	15	11	5	12	8	20
B1V7MN200620	20	06MA	20	11	5	12	8	20
B1V7MN200630	20	06MA	30	11	5	12	9	20
B1V7MN200640	20	06MA	40	11	5	12	9	20
B1V7MN200650	20	06MA	50	11	9	12	9	20
B1V7MN300430	30	04MA	30	22	9	14	17	20
B1V7MN300450	30	04MA	50	22	9	14	17	20
B1V7MN300510	30	05MA	10	22	9	14	17	20
B1V7MN300520	30	05MA	20	22	9	14	17	20
B1V7MN300530	30	05MA	30	22	9	14	17,5	20
B1V7MN300540	30	05MA	40	22	9	14	17,5	20
B1V7MN300550	30	05MA	50	22	9	14	18	20
B1V7MN300610	30	06MA	10	22	9	14	16	20
B1V7MN300615	30	06MA	15	22	9	14	16,5	20
B1V7MN300620	30	06MA	20	22	9	14	17,5	20
B1V7MN300630	30	06MA	30	22	9	14	18	20
B1V7MN300640	30	06MA	40	22	9	14	19,5	20
B1V7MN300650	30	06MA	50	22	9	14	21	20
B1V7MN300815	30	08MA	15	22	9	14	22	20
B1V7MN300820	30	08MA	20	22	9	14	23	20
B1V7MN300830	30	08MA	30	22	9	14	25	20
B1V7MN300840	30	08MA	40	22	9	14	28	20
B1V7MN300850	30	08MA	50	22	9	14	30	20
B1V7MN400620	40	06MA	20	26	11	18	22	20
B1V7MN400630	40	06MA	30	26	11	18	24	20
B1V7MN400640	40	06MA	40	26	11	18	26	20
B1V7MN400650	40	06MA	50	26	11	18	28	20
B1V7MN400815	40	08MA	15	26	11	18	26	20
B1V7MN400820	40	08MA	20	26	11	18	27	20
B1V7MN400830	40	08MA	30	26	11	18	28	20
B1V7MN400840	40	08MA	40	26	11	18	32	20
B1V7MN400850	40	08MA	50	26	11	18	37	20
B1V7MN400860	40	08MA	60	26	11	18	40	20
B1V7MN401020	40	10MA	20	26	11	18	34	20
B1V7MN401030	40	10MA	30	26	11	18	42	20
B1V7MN401040	40	10MA	40	26	11	18	46	20
B1V7MN401050	40	10MA	50	26	11	18	49	20
B1V7MN500815	50	08MA	15	32	15	20	35	20
B1V7MN500820	50	08MA	20	32	15	20	38	20
B1V7MN500830	50	08MA	30	32	15	20	43	20
B1V7MN500840	50	08MA	40	32	15	20	47	20
B1V7MN500850	50	08MA	50	32	15	20	50	20
B1V7MN501020	50	10MA	20	15	32	20	50	20
B1V7MN501030	50	10MA	30	15	32	20	55	20
B1V7MN501040	50	10MA	40	15	32	20	61	20
B1V7MN501050	50	10MA	50	15	32	20	66	20
B1V7MN501230	50	12MA	30	15	32	20	75	20
B1V7MN501240	50	12MA	40	15	32	20	78	20
B1V7MN501250	50	12MA	50	15	32	20	84	20
B1V7MN600830	60	08MA	30	16	34	21	84	20
B1V7MN600840	60	08MA	40	16	34	21	90	20
B1V7MN600850	60	08MA	50	16	34	21	95	20
B1V7MN601020	60	10MA	20	16	34	21	87	20
B1V7MN601030	60	10MA	30	16	34	21	90	20
B1V7MN601040	60	10MA	40	16	34	21	95	20
B1V7MN601050	60	10MA	50	16	34	21	100	20
B1V7MN601230	60	12MA	30	16	34	21	80	20
B1V7MN601240	60	12MA	40	16	34	21	86	20
B1V7MN601250	60	12MA	50	16	34	21	94	20
B1V7MN601450	60	14MA	50	16	34	21	102	20

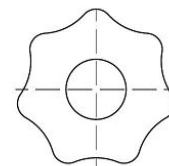
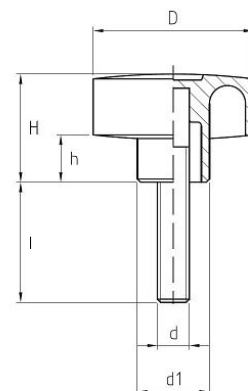

Caratteristiche

Materiale Corpo:

Tecnopolimero rinforzato con fibre di vetro, di colore nero, resistente a solventi, oli, grassi (PA)

Parte Metallica e/o Fissaggio:

Perno in acciaio zincato filettato, estremità smussate

Product specification

Main Part Material:

Black fiberglass-reinforced technopolymer, resistant to solvents, oils, greases (PA)

Metal and/or Fastening part:

Zinc plated steel threaded stud, rounded edges